

A BETTER RED

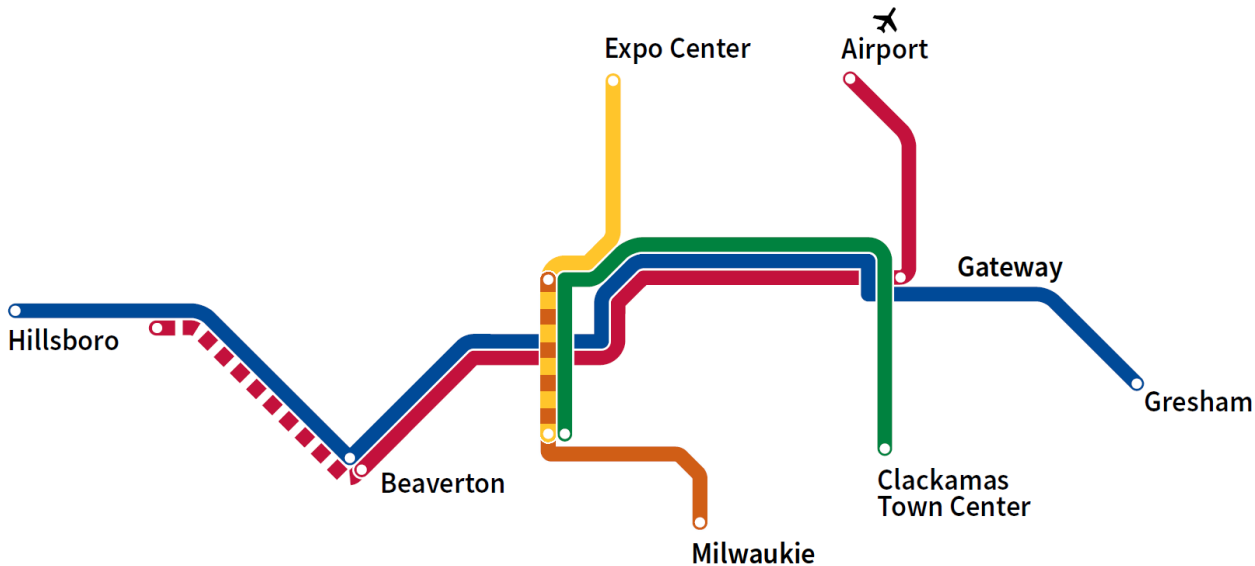

A Better Red extends MAX Red Line west to serve 10 more stations and improves schedule reliability for the entire MAX system.



Construction areas

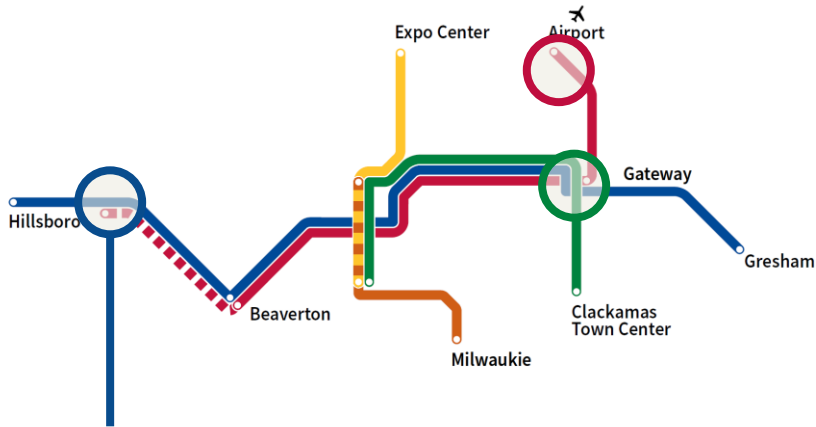

Fair Complex/Hillsboro Airport Station:

- Signals and switches
- New walkway and break facility for MAX operators



TRI  MET

Construction areas

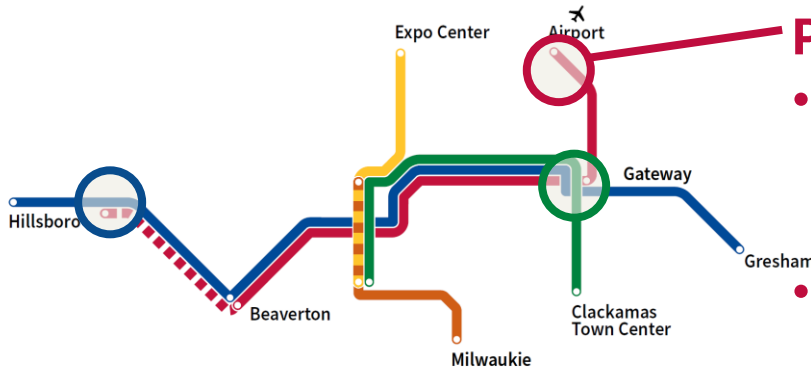

PDX:

- Second track at single-track bottleneck
- Rebuild station platform
- New MUP connecting PDX to NE 82nd Way



TRI  MET

Construction areas

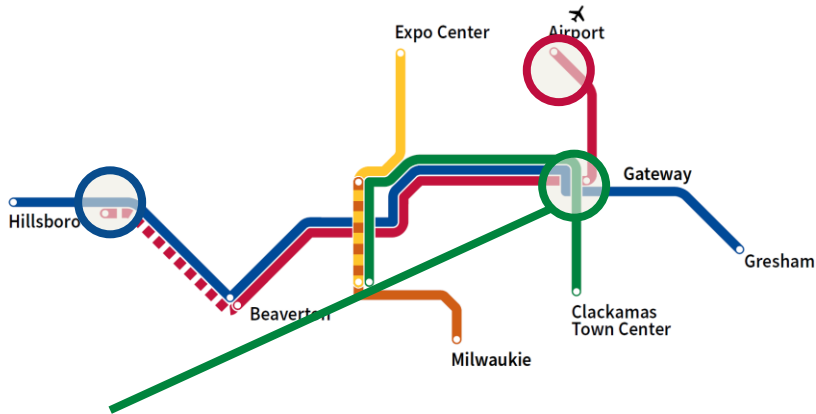

Gateway:

- Second track at single-track bottleneck
- Two bridges:
 - Over existing MAX track and I-205 MUP
 - Over I-84 and UPRR tracks, with new MUP to Gateway Green Park
- New station platform for Red Line trains heading toward City Center





Gateway highways

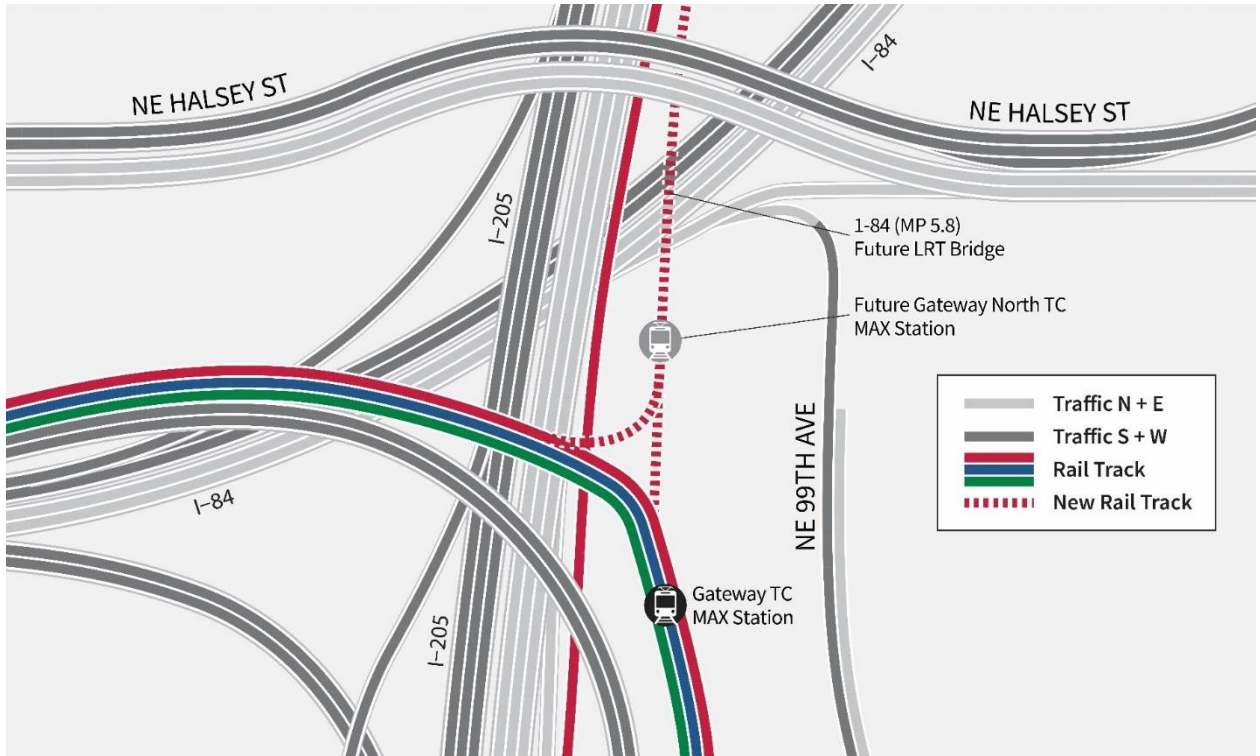

ESTIMATED PROJECT SCHEDULE



What to expect during construction

- MAX service interruptions, with shuttle buses (8)
- Lane closures, including nights on I-84
- Occasional closure of I-84 eastbound Exit 7–Halsey
- Weekend closures of I-84 westbound (2)
- Weekend closures of I-84 (2)
- Daytime pile driving adjacent to I-84
- MUP impacts
- Nighttime and weekend construction
- Partial parking and park closures

MAX service disruptions

For work at Fair Complex/Hillsboro Airport Station:

- 14 days - early 2023

For work at Gateway:

- **8 days - April 2-9**
- 2 days - spring 2022
- 2 days - summer 2022

- 21 days - spring 2023

- 8 days - fall 2023

- 9 days - early 2024

For work at PDX:

- 120 days - summer 2023

MAX Disruption April 2-9

- Shuttle buses from Gateway to PDX
 - Every 15 minutes
 - Will follow Red Line schedule
 - Regular schedule resumes April 10
- I-205 multi-use path impacts beginning mid-March
 - Closed between NE Maywood Place and Gateway Transit Center 9 p.m. – 5 a.m.
 - 15 minute intermittent closures during all other hours
- More information, please visit:

<https://news.trimet.org/2022/03/video-eight-day-disruption-planned-for-april-as-trimet-continues-work-on-a-better-red/>

TriMet's construction ethic

- Safety
- Minimize impacts to neighbors while maximizing construction efficiencies
- Community Affairs staff – liaison for neighbors
 - Gather information about access, operational needs
 - Collaborate with contractor to plan and adjust construction activities
 - Frequent communications; what to expect in advance; on-call 24/7
- trimet.org/betterred

trimet.org/betterred

HOME:
Video with
Gateway flyover

CONSTRUCTION:
Weekly updates

CONTACT:
Sign up for email
updates

